

Dr Brown's™

Soft Spout Transition Cup

Read and save these instructions for future use.

EN

BEFORE FIRST USE

Use clean hands and clean surfaces when handling. Disassemble and clean the product and then place the components in boiling water for 5 minutes. This is to ensure hygiene. Wash all parts prior to use. Be sure the spout/valve is clean.

BEFORE EACH USE

Pull on the spout/valve in all directions before each use to make sure it does not tear. Inspect carefully, especially when the child develops teeth, and replace the spout/valve immediately if it shows any signs of wear or damage, such as cracking or change of shape. Small pieces can accidentally be inhaled and cause serious injury. Clean before each use. The spout/valve must be clean and free of obstructions.

CLEANING

All parts are dishwasher safe (top rack only), and safe for use in electric sterilizer, microwave sterilizer or boiling water. Avoid overly aggressive cleaning of any parts to prevent damage to sealing surfaces.

ASSEMBLY & USE

Install the valve onto the underside of cap by **pressing firmly** into place, making sure edges are snapped all around. If your cup has removable handles, assemble handles with cap before tightening onto cup. Fill cup with liquid and tightly screw cap onto cup.

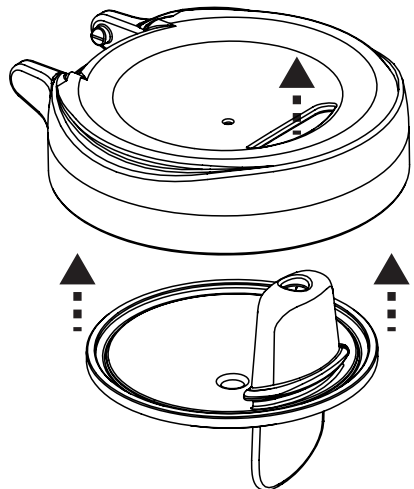

For your child's safety and health

WARNING!

- Continuous and prolonged sucking of fluids will cause tooth decay.
- Always check food temperature before feeding.
- Throw away at the first signs of damage or weakness.
- Keep components not in use out of the reach of children.
- Never attach to cords, ribbons, laces or loose parts of clothing. The child may be strangled.
- Never use spout/valve as a pacifier/soother.
- Always use this product with adult supervision.
- Always use the cup with spout/valve installed. The cup will not function properly without it.
- Always check the spout/valve for signs of wear and replace when damaged.
- Inspect the spout/valve before each use and pull the spout/valve in all directions. Throw away at the first signs of damage or weakness.
- Hot or carbonated liquids are not recommended.
- Do not use a microwave oven to heat the cup because microwave ovens can create hotspots in the cup, contents and/or components.
- The components of this cup are not toys and should not be given to children to play with or suck on.
- Do not leave the product in direct sunlight or heat or leave in disinfectant (sterilizing solution) for longer than recommended, as this may weaken the spout/valve.
- Do not allow a child to walk or run while using any cup.